



PIATTAFORMA DI LAVORO AUTOSOLLEVANTE

Mast climbing work platform | Plate-forme de travail
à levage automatique

JOLLY JR
S

JOLLY JR S

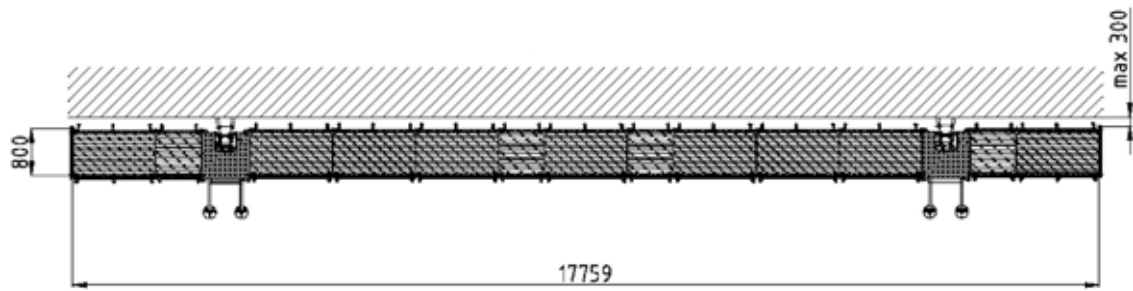

Traliccio tubolare - Tubular mast - Mât tubolaire

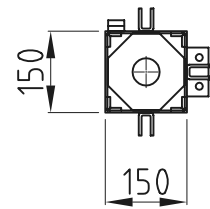
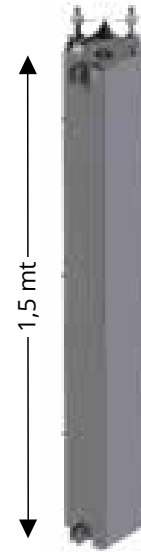
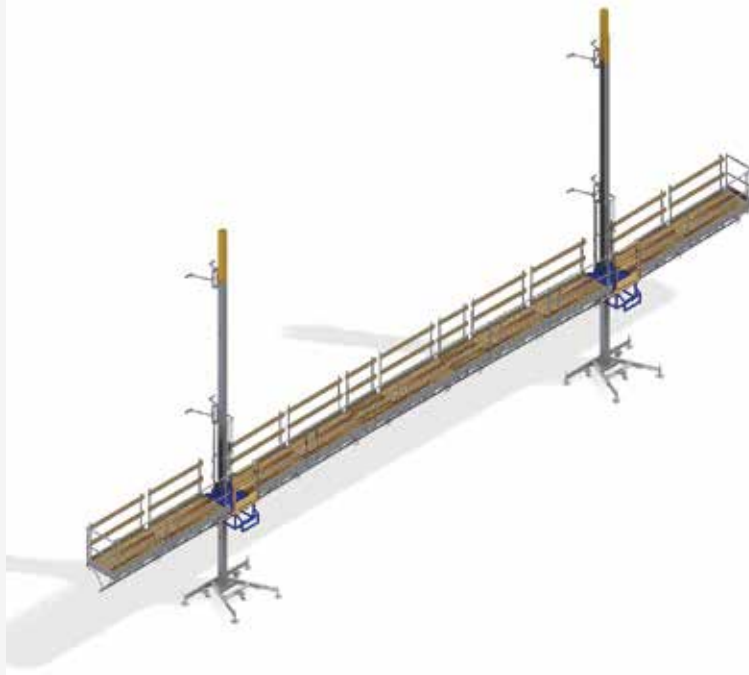

Kg = 40

DATI TECNICI	TECHNICAL DATA	DONNEES TECHNIQUES	JOLLY JR S	
N° di colonne	Number of masts	Nombre de mats	1	2
Portata max.	Max payload	Charge utile maximale	400 daN	800 daN
N° massimo di passeggeri	Max n° of passengers	N° de passagers admises	2	4
Altezza max. colonna	Max column height	Hauteur maxi de la colonne	≈100m	
Interasse max. ancoraggi	Max distance between anchors	Entraxe maxi entre les ancrages	6 m	
Lunghezza massima	Max lenght	Longeur maximale	5,30 m	17,80 m
Lunghezza estensioni a parete	Wall-side brakets lenght	Extension vers le paroi	0,60 m	
Potenza nominale	Rated power	Puissance nominale	1 x 1,5 Kw	2 x 2,5 Kw
Alimentazione	Power supply	Alimentation électrique	220÷240 / 380÷420 Vac 50Hz	
aCorrente di spunto	Inrush current	Courant de démarrage	20 A	40 A
Velocità di esercizio	Operating speed	Vitesse de travail	7,0 m/min	

